

# DocuPrint P285 dw / M285 z A4 Monochrome Single and Multifunction Printers

Designed to take your productivity to the next level



# Smart, Powerful and Efficient Performance

The Fuji Xerox DocuPrint P285 dw and M285 z are the perfect solution for small and medium business workgroups who require high quality, fast and efficient monochrome printing with flexible connectivity capabilities in a compact size.

## PERFORMANCE AND RELIABILITY

- **Speed and Quality** – With speeds of up to 34 pages per minute – the 285 series supports print resolutions of up to 1200 x 1200 dpi, delivering the highest quality, faster print speed and first-page-out-time.
- **Innovation and Reliability** – Building on Fuji Xerox's reputation for reliability the entire range includes simple engineering, easy operation and outstanding printing designed to give trouble free printing whenever you need it.
- **Single Pass Duplex Automatic Document Feeder (SPDADF)** – the DocuPrint M285 z comes equip with 50-sheet feeder to be scanned in one single pass, reducing processing and waiting time.

## AFFORDABLE, EFFICIENT PRINTING

- **Lower running costs** – Printer costs are far more than the initial purchase, and this range of Fuji Xerox printers is designed to keep overall running costs lower to suit your business needs with a choice of 3K toner or 4.5K toner.
- **Reduced toner use** – With toner save mode, the printers can extend the life of your toner cartridge by varying the toner density during printing, saving money with every print.
- **Use less paper** – By using the clever N-UP print feature, you can print multiple pages on a single sheet of paper, saving toner as well as paper, reducing the costs of your printing even further.

## INCREASE PRODUCTIVITY WITH SMART FEATURES

- **Duplex Printing and WiFi as standard across the range** – With duplex printing standard across the range, these printers offer increased productivity and reduced costs combined with ease of use.
- **Easy to use touch screen Interface** – the DocuPrint M285 z features a 2.7" colour touch screen interface that is simple to use. Quickly produce the quality prints you need through the clear, simple interface that makes walk up functions easy to access.
- **Clever ID Card Copying** – This allows you to quickly copy both sides of an ID card onto one piece of paper, just copy one side, then the reverse and the printer does the rest. No need to move paper, put the card in a different location, just a quick, easy solution that saves time and money.



### CLEVER ID CARD COPYING

The easy-to-use ID card copy feature allows you to copy both sides of the card onto the same side of the paper. Simply place an ID card both face up & down on the copier surface, pressing the start button each time.

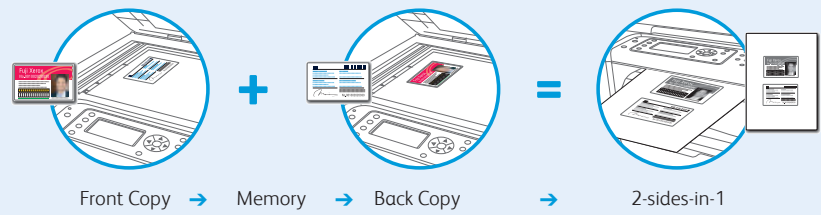

### STAY CONNECTED WITH ADVANCED MOBILE PRINT CONNECTIVITY

Whatever device you need to print from, you can do so quickly and easily.

The DocuPrint P285 dw / M285 z feature the most comprehensive connectivity solutions available today.



#### AirPrint

Effortlessly print with an AirPrint-enabled printer from your iOS devices without the need to install a driver or configure the printer queue.



#### Google Cloud Print Ready

Simply connect your Fuji Xerox printer to the Internet. Allows you to print from any applications running on a phone, tablet, chrome device, PC and any other web-connected device directly onto the printers.



#### Wi-Fi Direct

Seamlessly connect and print quickly and easily with your Wi-Fi Direct enabled device without the use of an access point.



#### Fuji Xerox Print Utility

Whether it is an iOS or Android device, the Fuji Xerox Print Utility enables users to print and scan conveniently and directly at your fingertips. Download the app today from the App Store for iOS or Play Store for Android.



#### Mopria Certified

Print your business documents with your Android smartphones and tablet devices by connecting to any Mopria-certified Fuji Xerox printer. Mopria print services can be downloaded free from Google Play™ Store (Android™ 4.4 or later).



#### Near Field Technology

Simply tap to connect, print or scan with an NFC enabled device.



Users can tap any NFC enabled device to print or scan via Fuji Xerox Print Utility\*. Simply select the photo or document you wish to utilise and tap your device to your DocuPrint P285 dw / M285 z.

\*To enable this you must install the Fuji Xerox Print Utility App.

# DocuPrint P285 dw / M285 z Specifications

Product Name	DocuPrint P285 dw	DocuPrint M285 z
Function	A4 Monochrome Printer	A4 Monochrome Multifunction
Print Function	Up to 34 ppm	
Print Speed (A4) <sup>1</sup>	Up to 8 ppm (16 sides per minute)	
Duplex Print Speed (A4)	Up to 1200 x 1200 dpi at full speed	
Print Resolution	7 seconds or less	
First-page-out Time (A4 SEF) (At 23°C from ready mode)	4 seconds or less (from Sleep Mode)	
Warm-up Time at 23°C	26 seconds or less (from Power Up)	28 seconds or less (from Power Up)
Memory	128 MB	256 MB
Processor	600 MHz	
PDL	PCL6, PS3 emulation	
Operator Panel	1 line LCD	2.7" Colour Touchscreen
Connectivity	Wireless, 10 Base-T/100Base-TX Ethernet, USB2.0 Hi-Speed	
Network protocol	IPv4: ARP, RARP, BOOTP, DHCP, AP/PA(Auto IP), WINS/NetBIOS name resolution, DNS resolver, mDNS, LLNMR responder, LPR/LPD, Custom Raw Port/Port 9100, IPP/IPPS, (FTP Server), SNMPv1/v2c/v3, HTTP/HT TPS Server, TFTP Client and Server, SMTP Client, ICMP, Web Services (Print)	
Mobile Print	IPv6: NDP, RA, DNS Resolver, mDNS, LLNMR responder, LPR/LPD, Custom Raw Port/Port 9100, IPP/IPPS, FTP Server, SNMPv1/v2c/v3, HTTP/HT TPS Server, TFTP Client and Server, SMTP Client, ICMPv6, Web Services (Print)	
Supported Operating System <sup>2</sup>	AirPrint, Google Cloud Print, FX Print Utility for iOS and Android, Mopria Certified, Near Field Technology (NFC)	
Automatic Duplex Printing	Windows <sup>®</sup> 7(32/64), Windows <sup>®</sup> 8.1(32/64), Windows 10(32/64), Windows Server 2008 (32/64), Windows Server 2008 R2, Windows Server 2012, Windows Server 2012 R2, Windows Server 2016 <sup>3</sup> Mac OS X v, 10.11, 10.12, 10.13 <sup>4</sup>	
Input Paper Size (Paper Tray)	Yes	
Media Input Capacity (Paper Tray)	ANZ/TW/KR/CH config : A4 SEF, Letter SEF, A5 SEF/LEF, A6 SEF, 16K(China only), 210x270mm(Taiwan only)	
Media Input Capacity (Multi-purpose Tray)	AP/IDN config Universal Tray: Folio (8.5" x 13") SEF, Legal SEF, Executive, A4 SEF, Letter SEF, A5 SEF/LEF, A6 SEF	
Input Paper Size (Multi-purpose Tray)	250 sheets 80gsm	
Media Output Capacity	30 sheets	
Media Types (Main Tray, or Duplex)	Width 76.2-216 mm, Length 127-355.6mm Envelope (COM-10, Monarch, C5, DL)	
Media Types (Multi-purpose Tray)	150 sheets 80gsm (Face down), 1 sheet (Face up with rear cover open)	
Input Paper Weight (Paper Tray)	120 sheets 80gsm (Face down), 1 sheet (Face up with rear cover open)	
Input Paper Weight (Multi-purpose Tray)	Plain paper, Thick paper, Recycled paper, label, envelope, bond paper	
Automatic Document Feeder	60 to 163 gsm	
Single-pass Duplex Automatic Document Feeder	60 to 230 gsm	
Monthly Max. Duty Cycle	Yes	
Machine Life	Up to 50 sheets	
Print Features	15k pages	
Dimensions (WxDxH)	50K page (Duplex 25k page) or 5 years	
Weight (without supplies)	Toner Save Mode, N-up(2,4,9,16, or 25) <sup>5</sup> , Poster <sup>6</sup> (4,9,16,25), Header/Footer <sup>7</sup> (time & date and/or user ID), Watermarks <sup>8</sup> , manual duplex printing <sup>9</sup> , manual booklet printing <sup>5</sup>	
Operating Environment Temperature	356.0 x 388.0 x 183.0 mm	
Humidity	410.0 x 426.5 x 318.5 mm	
Acoustics: Sound Pressure Level	6.9 kg	
Electrical Power	Storage: 0° C to 40° C, Operating: 10° C to 32.5° C	
Power consumption <sup>2</sup>	Operating Environment: 20% to 80%RH (without condensation), 23° C 10%	
TEC value	Printing: 49 dB(A) or less	
Wireless Specification	Ready: 30 dB(A) or less	
Wireless LAN	For AP & China model (excluding Taiwan): 220-240 VAC, 50/60 Hz	
Wireless Network Security	For Taiwan model : 110-120 VAC, 50/60 Hz	
Network security (Wireless)	Ready/Standby: 48/48W (220-240V/110-120V);	
Wireless Certification	Printing: Approx. 510/546W (220-240V/110-120V);	
NFC	Deep Sleep: 0.6/0.6W (220-240V/110-120V);	
Copy Function	Ready/Standby: 42/43.5W (220-240V/110-120V);	
Copy Speed (A4) <sup>1</sup>	Printing: Approx. 475/450W (220-240V/110-120V);	
Copy Resolution	Deep Sleep: 1.1/1.2W (220-240V/110-120V);	
First-copy-out Time	1.2 kWh/week 220-240V	
Simplex at 23°C from ready mode)	1.4 kWh/week 110-120V	
Reduction / Enlargement	1.3 kWh/week 220-240V	
Multi-Copy	1.5 kWh/week 110-120V	
Copy Feature	ID Card Copy, N in 1 copying (N=2, 4), Sort (Up to 99 pages)	
Automatic 2-sided copy	Yes	
Scan Function	Yes	
Type	Colour CIS	
Automatic 2-sided scan	Yes	
Scanning Resolution	Optical (Scanner Glass) up to 1200 x 1200 dpi / (ADF) up to 600 x 600 dpi (mono/colour)	
Scan Depth	Enhanced: up to 19,200 x 19,200 dpi <sup>7</sup>	
Document Size	Output 8 bit	
Scan Destinations	Platen: max 215.9mm x 300mm; ADF: max Width 105-215.9 x Length 147.3-355.6mm	
Supported Driver	Scan to PC and application (Email, Image File) by ControlCenter utility, Scan to FTP	
Fax Function	Windows <sup>®</sup> : TWAIN, WIA for Windows Windows <sup>®</sup> 7/Windows <sup>®</sup> 8.1/Windows <sup>®</sup> 10	
Compatibility	AirPrint usage (TWAIN, ICA) for OS 10.11/10.12/10.13	
Communication System	ITU-T Super G3	
Modem Speed	PSTN	
Memory Transmission	Up to 33.6Kbps	
Out-of-paper reception	up to 500 pages *	
Fax Resolution	up to 500 pages *	
Speed Dials	Superfine 8dot/mm x 15.4line/mm	
Broadcasting	Up to 200 locations	
Fax Features	Up to 250 locations	
Warranty	PC Fax Send and Receive (Windows Only)	
Consumables	Please check with your Fuji Xerox Printers reseller for more information	
Shipped consumables	Approx. 3,000 <sup>1</sup> pages toner and approx. 12,000 <sup>5</sup> pages drum	
Toner cartridge – High Capacity (3,000 pages) <sup>1</sup>	CT202877	
Toner cartridge – Extra High Capacity (4,500 pages) <sup>1</sup>	CT202878	
Drum Cartridge <sup>6</sup> (12,000 pages)	CT351134	

<sup>1</sup> Print/copy speed may decrease due to factors such as paper type, paper size, and printing conditions. <sup>2</sup> Measure when the machine is connected to the USB interface. <sup>3</sup> Declared yield in accordance with ISO/IEC 19752. Yield will vary based on image area coverage and print mode. <sup>4</sup> Drum yield may vary by the type of use. <sup>5</sup> Windows Only <sup>6</sup> Mac drivers are available by web download. <sup>7</sup> Max 1200 x 1200 dpi scanning with WIS (Windows Image Acquisition) driver in Windows 7 and Windows 8.1 up to 19200 x 19200 dpi can be chosen by using the scanner utility. <sup>8</sup> Only network printing supported on Windows Server OS. <sup>9</sup> N-up for Mac (2,4,6,9, or 16). All product names and company names mentioned in this brochure are trademarks or registered trademarks of their respective companies. \* ITU-T Test Chart, Standard resolution



This product has been tested and found to comply with the Class 1 Laser Equipment requirements defined by the international standard IEC60825-1:2007 and has no light exposure hazard. The product has no hazardous light emission as it features light protection components and covers to shut in all light beam during operation and maintenance. Internal Laser radiation Wave length: 770 - 800 nm. Output: 25 mW max. Laser Class: Class 3B

**Reproduction Prohibitions** Please note that reproduction of the following is prohibited by law: Domestic and foreign currencies, government-issued securities, and national bonds and local bond certificates. Unused postage stamps, post cards, etc. Certificate stamps stipulated by law. Reproducing works forming the subject matter of copyright (literary works, musical works, paintings, engravings, maps, cinematographic works, drawings, photographic works, etc.) is not permitted unless the reproduction is for the purpose of personal use, family use or other similar uses within a limited circle.

**For Your Safety**  
 Before using the product, read the Instruction Manual carefully for proper use. Use the product with the power source and voltage specified. Be sure to establish ground connection. Otherwise, electronic shock may result in the case of a failure or short circuit.

# astragraphia

member of ASTRA

Halo Astragraphia  
**1500 345**  
 www.DocumentSolution.com

Let's Be Friends ☺



astragraphia document solution



@astragraphia\_ds @astragraphiadocsol